

BENLEE

The BENLEE Super Mini and Super Mini Long roll-off trailers set a new benchmark for the industry. Backed by an industry-leading 6-year frame warranty and built with extreme-duty components, these trailers deliver unparalleled durability and performance. What others consider premium upgrades come standard with BENLEE.

Amid rising roll-off truck costs, the Super Mini line offers a cost-effective and robust solution. With up to a 40% tighter turning radius, compatibility with 10-60 yard containers, and up to 80% greater legal payload capacity, these trailers easily outperform the competition. Their detachable design reduces truck downtime and, when paired with a converter dolly, can transform into a live pup, adding versatility and boosting revenue potential.

BENLEE is synonymous with safe operation, maximum uptime, and the lowest total cost of ownership in the industry. Choosing BENLEE means investing in proven quality, long-term performance, and exceptional value.



Model Shown: TASMR526S

- **102" Wide Axles:** Ensures maximum load handling stability
- **25,000 lb. Axles / Suspension:** Extreme-duty components for robust performance and durability
- **1" Chromium Trivalent Plated Steel Lines:** Corrosion resistant, extends life of hydraulic system
- **1" Tough Cover Hoses:** 3,000 psi rating, superior weather resistance, and rupture protection
- **Premium Parker DVA35HD Valve Assembly:** Handles high pressure and flow with ease
- **Becket Cable Securement System:** Unmatched anti-slip protection under heavy loads
- **Secondary Air Filter:** Guards against contamination, extending ABS warranty to 4 years / 400,000 miles
- **5-Year Sealed Hubs:** Reduced maintenance, lower total ownership cost, and enhanced uptime
- **Hoist Up Alarm:** Premium proximity sensor and LED strobe light ensure clear visual warnings
- **16-Ply / SmartWay Certified Tires:** Greater durability, improved uptime and more fuel efficiency
- **Fast-Flap Mudflap System:** Low-maintenance, fewer DOT fines, and quick easy adjustments
- **Premium Finish:** Sand blasted, primed, and painted for a durable, long-lasting finish

There's Nothing Mini About the BENLEE SUPER MINI

SUPER MINI®



Manitowoc • Huge Haul • BENLEE • Two-Container Trailer • Roll-off Truck • Gondola • Roll-off Pup Trailer • Roll-off Converter Dolly • Dump Trailer Mini
Roll-off Containers • Roll-off Truck Replacement • Lumber Truck • Crushed-Car Hauler • Super Mini® • BridgeMaster • Conventional • Drop Deck • Drop Deck Mini

MODEL	AXLE CONFIG.	GVW	OVERALL LENGTH	GROUND TO ROLLER HEIGHT	TARE WEIGHT	CONTAINER LENGTHS	PAYLOAD
TASMRS26S	FF	70,500 lb.	311.3"	58.5"	12,400 lb.	12' - 24'	40,100 lb.
TASMD528S (CAN)	FF	70,500 lb.	335.5"	58.5"	12,800 lb.	12' - 24'	39,700 lb.
TASLDS33F	FF	72,500 lb.	398.5"	58.5"	13,650 lb.	12' - 31'	40,850 lb.
TRSLDS33F	AFF	77,500 lb.	398.5"	58.5"	16,300 lb.	12' - 31'	43,200 lb.
TRSLDS34S	AFF	80,000 lb.	407.8"	58.5"	17,050 lb.	12' - 32'	44,950 lb.

BENLEE's SUPER MINI and SUPER MINI LONG have the following tractor/truck requirements: 5th wheel, 7-way electrical connection, gladhand air lines (service and emergency), wet kit (2-line: pressure and return), 60 gal. hydraulic tank, 32 ISO-VG hydraulic oil, oil flow of 25-30 gpm, max. operating pressure of 2,200 psi, and a pump capable of 1,600 to 1,900 rpm (*continuous operation*). BENLEE recommends the push-to-connect "quick" hydraulic couplers in lieu of wing couplers, to prevent any possibility of flow restriction (*however, either will work*). **PAYLOAD = box + contents** (start with GVW shown above, subtract tractor weight (assumes 18,000 lb.), subtract unit tare weight shown above).

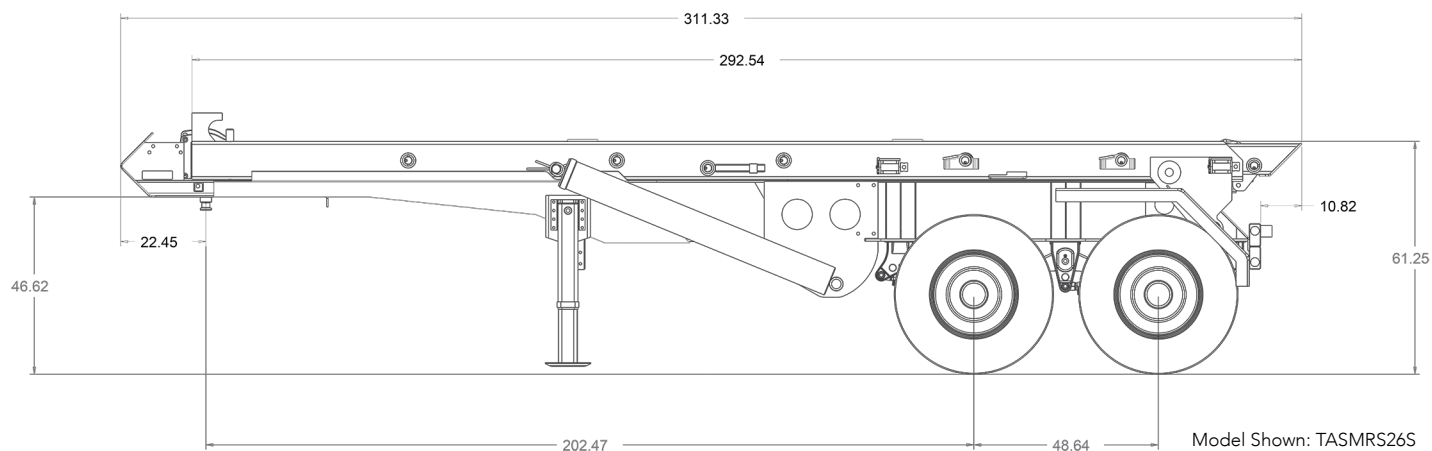

FEATURED OPTION: Auto Inflation System w/Axle Heat Sensor

A highly recommended upgrade, though not essential for operation, is the auto inflation system with axle heat sensor. It ensures tires remain at the correct PSI while the truck is running and the trailer is connected, even if they develop a slow leak from a nail or rock. This system monitors air pressure, providing visual alerts to the operator if any issues arise. Additionally, it monitors axle temperatures to help prevent bearing overheating.

- Reduces chance of fire on vehicle itself or unintentionally igniting roadside brush
- Reduces road service calls (*fewer flats save time and money*)
- Reduces DOT fines for flat tires
- Reduces costly axle damage
- Increases tire life expectancy by as much as 10%
- Increases ability to recap tires (*casings are not destroyed*)
- Average fuel savings of 1%

For more information, visit:
www.psitireinflation.com

AVAILABLE OPTIONS:

- Automated Tarp System w/Work Lights
- Auto Inflation System w/Axle Heat Sensor
- Air-Ride Suspension w/Digital Scale
- Spare Tire Rack
- Inside Cab Controls
- Wireless Remote Control
- Advanced Wireless Camera System
- Automated Grease System

- Rear Work Lights
- Intermittent Stops (*accommodates short containers*)
- Onboard Scale (*spring suspension*)
- Tool Box (24", 36" or 48" lengths - steel or aluminum)
- Front Fenders (*steel, stainless steel, aluminum or poly*)
- Rear Fenders (*stainless steel, aluminum or poly*)
- Aluminum Wheels (*120 lb. per axle weight reduction*)
- Hubometer
- Disc Brakes
- I/O - Inside/Outside Rail & Dead Lift Configurations

SAFETY FIRST



BENLEE provides an industry-leading 6-year frame warranty to the original retail purchaser. Warranty covers against defects in material and workmanship. Wear items or components such as paint, cables, rollers, etc...are not warrant-able. BENLEE's obligation is limited to repair or replacement of defective parts or components. Purchased components are covered in accordance with the original OEM's warranty policy. All warranty related work, repairs and/or installation must be pre-approved by BENLEE to qualify for reimbursement, then executed by BENLEE or an approved service center. BENLEE also reserves the right to make product improvements or changes at any time, without prior notice.

©BENLEE | www.benlee.com | 30383 Ecorse Road, Romulus, MI 48174 | (734) 722-8100

Service-Support: [Request](#) | Roll-off Parts Store: [Shop Now](#) | **FREE** Weekly Commodities / Economic Video: [Watch Now](#)

