

Model: HL-30-120

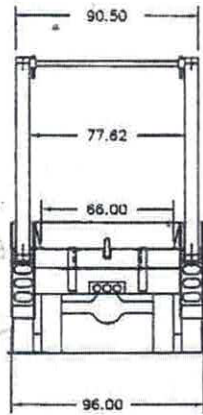
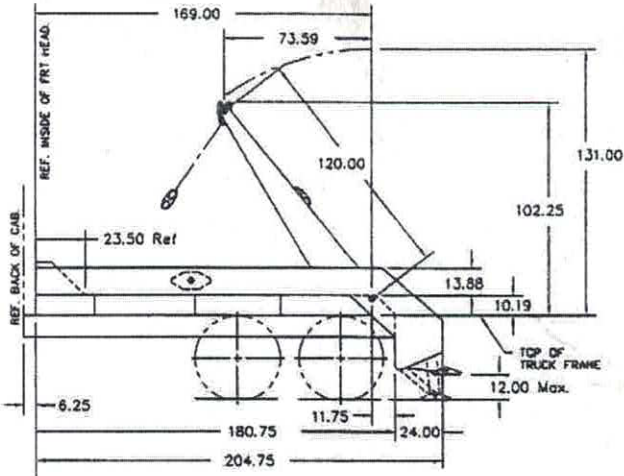

- Gross Lifting Capacity.....30,000 lbs
- Standard Capacity Sizes.....10-20 yd³
- Approximate Weight.....7,400 lbs
- Hydraulic Pump Capacity @ 1200 rpm.....24 gpm
- Operating Pressure.....2,500 psi
- Arm Cylinders7.5" x 2.5" x 47.5"
- Jackleg Stabilizers.....4.5" x 4" x 11"
- Cycle Time Up @ 1200 rpm.....36 sec
- Cycle Time Down @ 1200 rpm.....41 sec

Minimum Truck Requirements

- Front Axle.....16,000 lbs
- Rear Axle.....38,000 lbs
- GVW.....54,000 lbs
- B.O.C. to C/L of Tandem.....138 in
- B.O.C. to End of Frame.....188 in

Model: HL-40-120

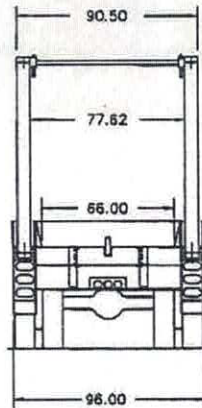
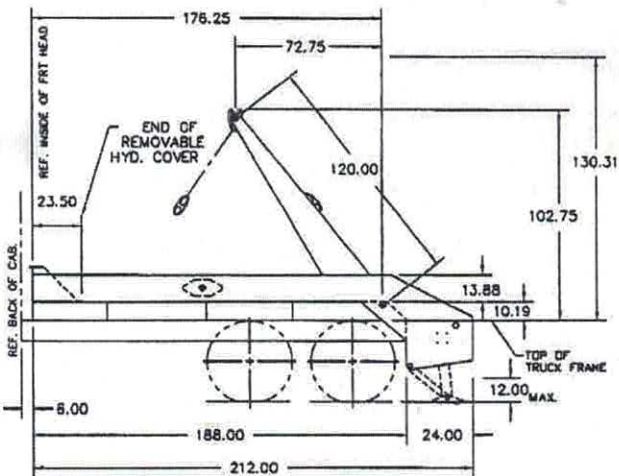

- Gross Lifting Capacity.....40,000 lbs
- Standard Capacity Sizes.....10-28 yd³
- Approximate Weight.....7,900 lbs
- Hydraulic Pump Capacity @ 1200 rpm.....29 gpm
- Operating Pressure.....2,500 psi
- Arm Cylinders8" x 3" x 59.5"
- Jackleg Stabilizers.....4.5" x 4" x 11"
- Cycle Time Up @ 1200 rpm.....43 sec
- Cycle Time Down @ 1200 rpm.....50 sec

Minimum Truck Requirements

- Front Axle.....18,000 lbs
- Rear Axle.....44,000 lbs
- GVW.....62,000 lbs
- B.O.C. to C/L of Tandem.....144 in
- B.O.C. to End of Frame.....194 in

Model: HL-50-120

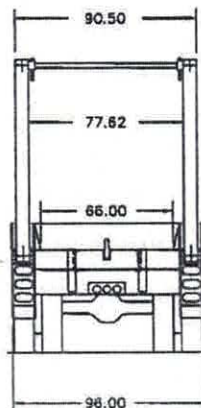
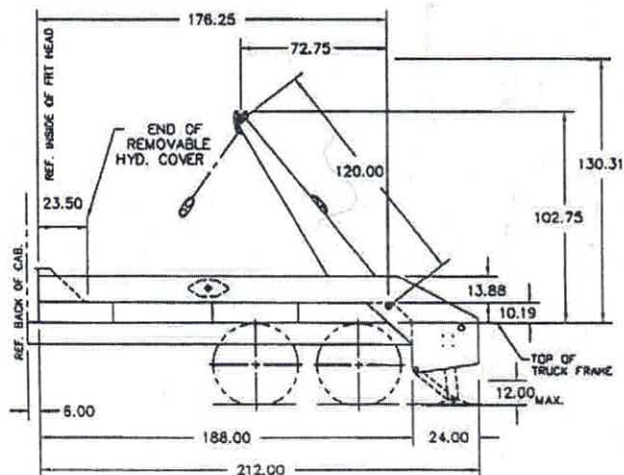

- Gross Lifting Capacity.....50,000 lbs
- Standard Capacity Sizes.....10-28 yd³
- Approximate Weight.....9,800 lbs
- Hydraulic Pump Capacity @ 1200 rpm.....33 gpm
- Operating Pressure.....2,500 psi
- Arm Cylinders8" x 3.5" x 59.5"
- Jackleg Stabilizers.....4.5" x 4" x 11"
- Cycle Time Up @ 1200 rpm.....53 sec
- Cycle Time Down @ 1200 rpm.....47 sec

Minimum Truck Requirements

- Front Axle.....20,000 lbs
- Rear Axle.....44,000 lbs
- GVW.....64,000 lbs
- B.O.C. to C/L of Tandem.....144 in
- B.O.C. to End of Frame.....194 in